



ENCROACHMENT APPLICATION

ORDINANCE # 12456

PERMANENT X
TEMPORARY _____
APPLICATION DATE 2/8/19

PERMIT NO. _____
DATE ISSUED _____
FEE PAID _____

INFORMATION TO BE FAXED TO THE ENGINEERING DEPARTMENT AT (610) 437-7614
PLEASE PRINT OR TYPE CLEARLY WITH BLUE OR BLACK INK

ADDRESS OF ENCROACHMENT: Various (Please see attached)
TIME PERIOD APPLIED FOR: Permanent
TYPE OF ENCROACHMENT: Meter Kiosk Installation
IF DUMPSTER OR SCAFFOLDING: N/A
NAME OF SUPPLIER: N/A PHONE: _____
ADDRESS: N/A
NAME OF PROPERTY OWNER: Allentown Parking Authority PHONE: 610-841-9090
ADDRESS: 603 W. Linden Street Allentown, PA 18101
NAME OF APPLICANT: George J. Grazer, Jr. PHONE: 610-841-8822
ADDRESS: 603 W. Linden Street Allentown, PA 18101
APPLICANTS SIGNATURE: George J. Grazer, Jr.

ALL APPLICATION TO BE ACCOMPANIED BY A MEASURE SKETCH BELOW

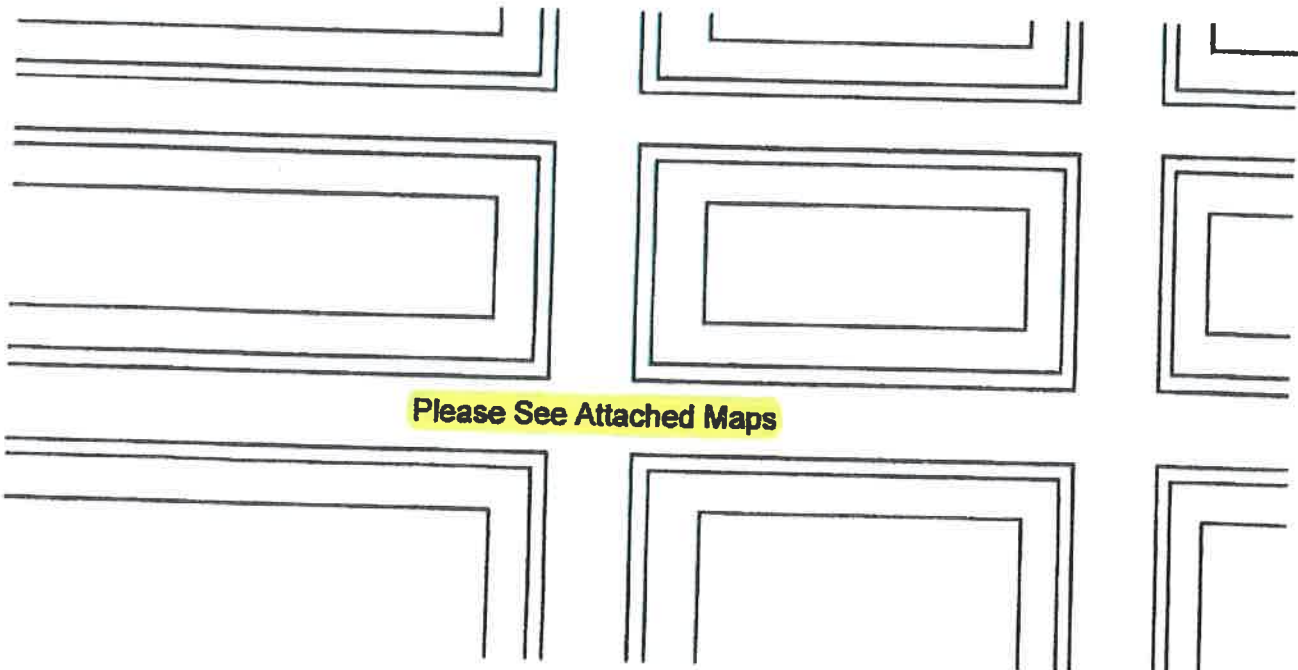

ROUTING SHEET

BUREAU OF DIVISION	DATE REC'D	DATE REVIEW COMPLETED	DATE APPROVED	*DATE REJECTED
<i>DKK</i> HARB	2/5/2019	2/5/2019	2/5/2019	
<i>ES</i> ENG.	2/4/19	2/4/19	2/4/19 *	
MPW INSP.	2/5/19	2/6/19	2/6/19	
<i>TL</i> TRAFFIC	2/8/19	2/8/19	2/8/19	
OTHER				

Upon completion of review by those Bureaus/Divisions/Agencies checked above, return application to the Director of Code Enforcement (Building Standards and Safety – Inspection Division). If rejected Manager of Bureau/Division/Agency is to attach memo explaining reason(s).

If rejected or not permitted in accordance with the Ordinance, forward to the City Clerk for action by City Council.

✓

Approved

Rejected

Orang Messing

Director, Community Development or Designee

2/9/19

Date

* NEED COUNCIL APPROVAL - MORE THAN 1/3 OF PUBLIC RIGHT OF WAY.

ALL APPLICATION TO BE ACCOMPANIED BY A MEASURE SKETCH BELOW

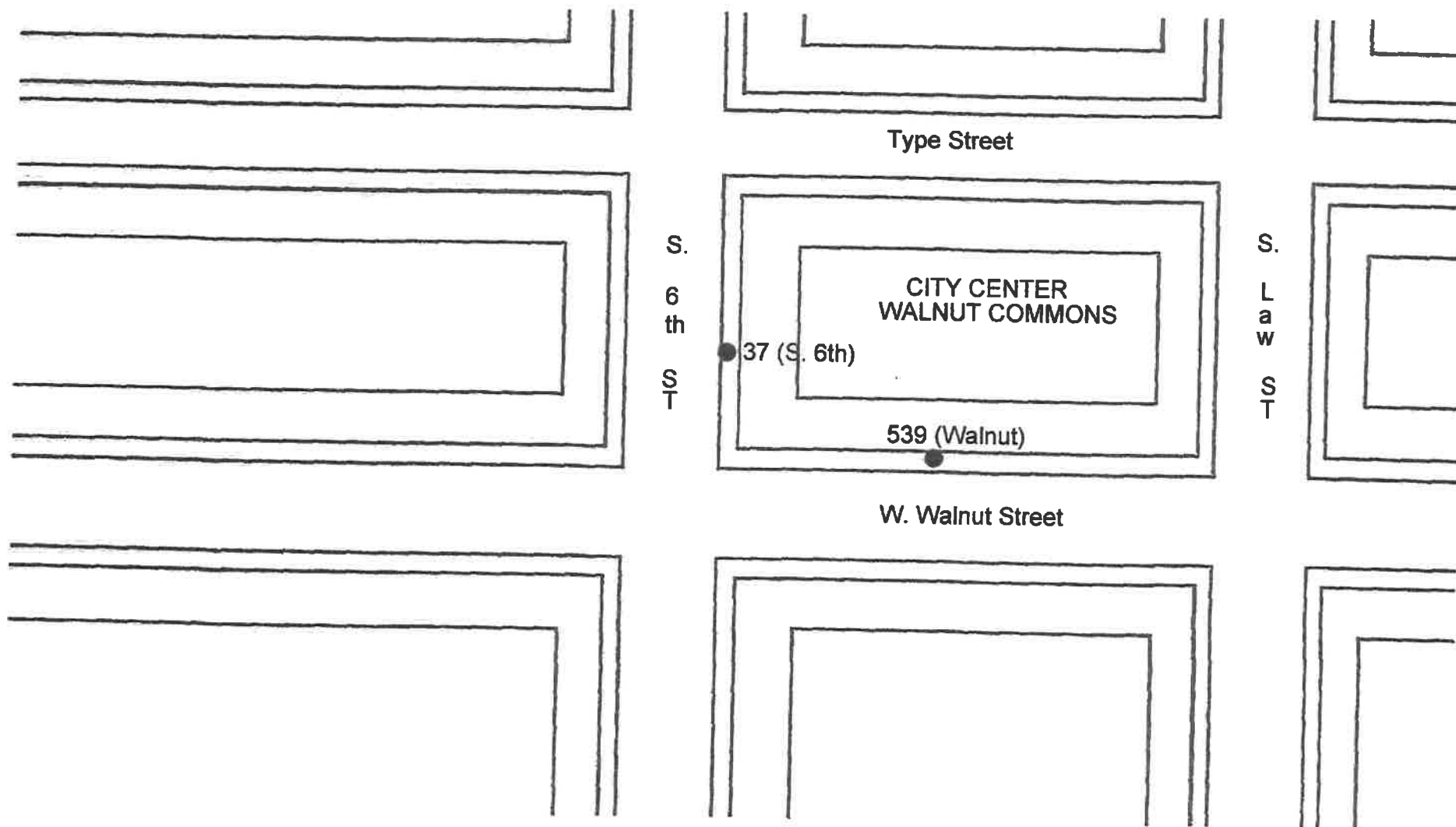

ALL APPLICATION TO BE ACCOMPANIED BY A MEASURE SKETCH BELOW

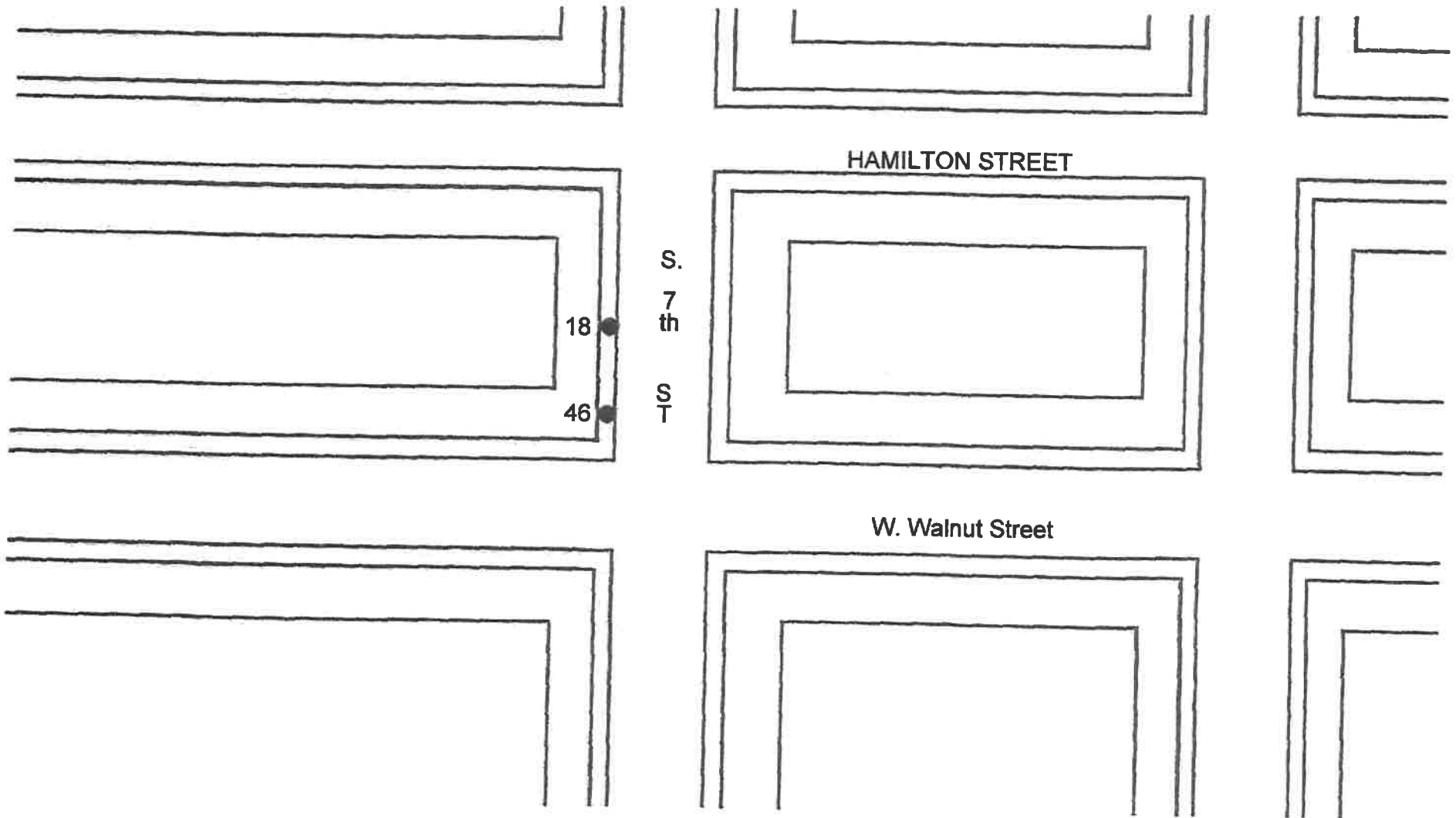

ALL APPLICATION TO BE ACCOMPANIED BY A MEASURE SKETCH BELOW

