





LEGEND

-  WORK AREA
 TEMPORARY EB DETOUR
 TEMPORARY WB DETOUR
 PARKS/RECREATIONAL AREAS

SCALE
0 200 400 FEET

COMMONWEALTH OF PENNSYLVANIA
DEPARTMENT OF TRANSPORTATION

LEHIGH COUNTY
SR 7301 SECTION 01B
OVER JORDAN CREEK
PROJECT LOCATION & DETOUR

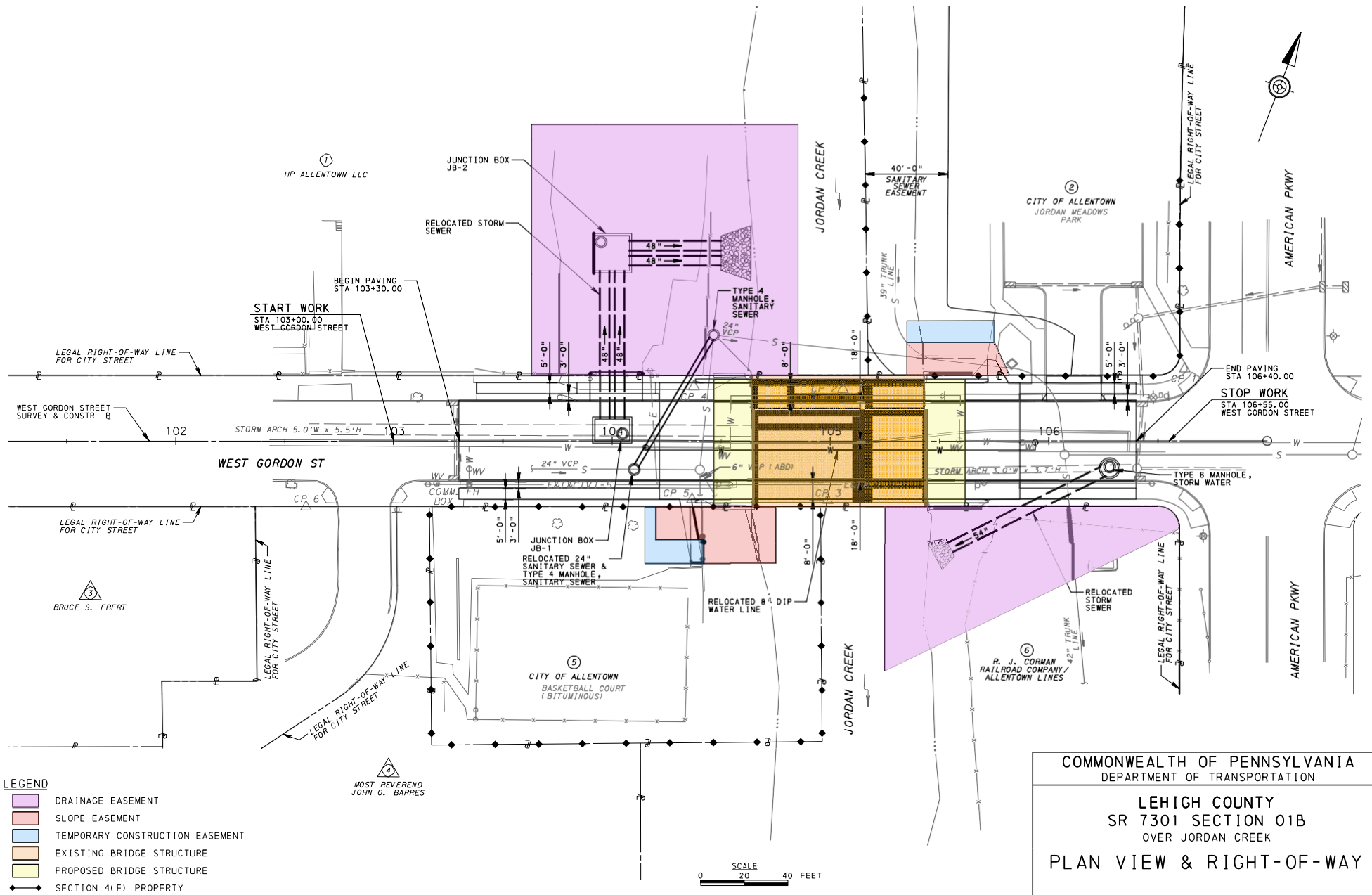

EXISTING

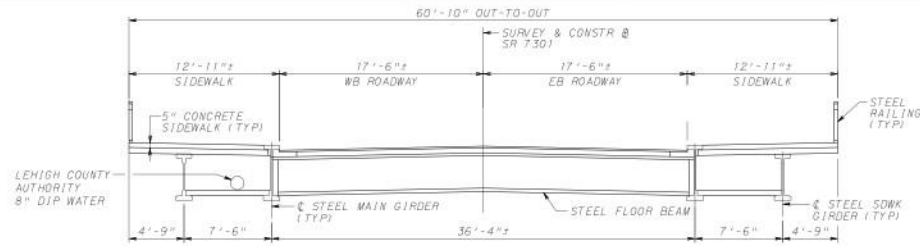

STAGE 1

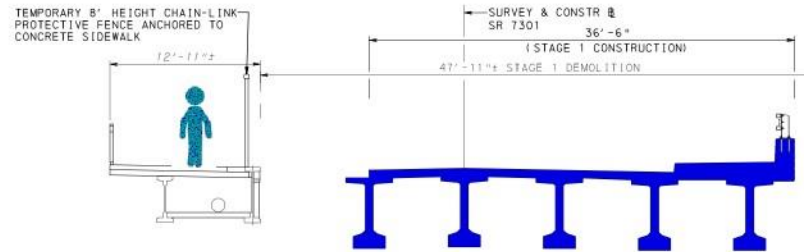

LEGEND

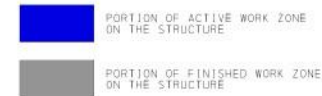

STAGE 2

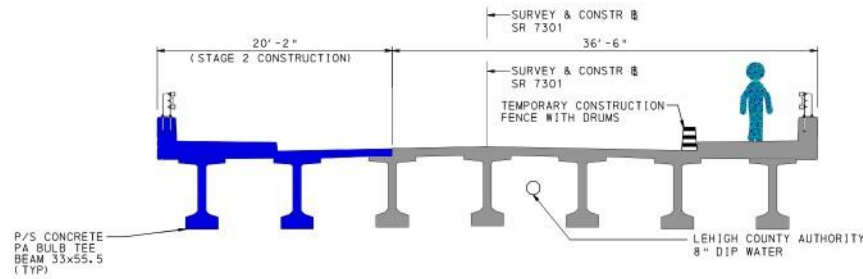

COMPLETE

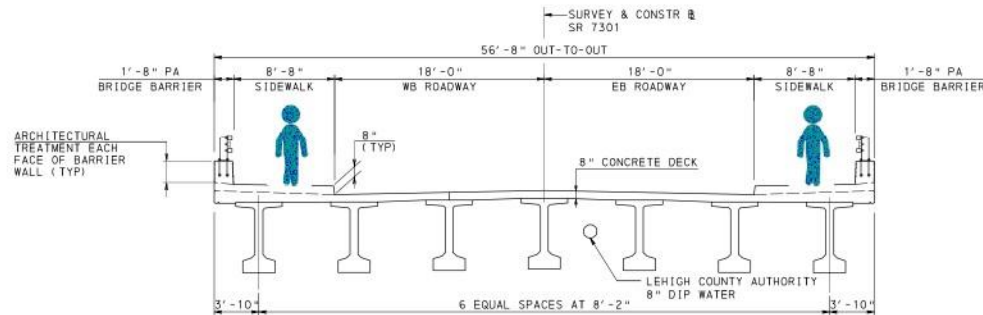

LOOKING EAST

COMMONWEALTH OF PENNSYLVANIA
DEPARTMENT OF TRANSPORTATION

LEHIGH COUNTY
SR 7501 SECTION 01B
OVER 30RDAN CREEK

CONSTRUCTION STAGING